

Why Have Noise Zones?

Everyone who visits the Palatine Public Library District deserves a great place to read, work and socialize.

In an effort to better serve our patrons, the Main Library is designating zones which permit different noise levels and activities.

Please Remember

The Library is here for everyone.

All visitors have the right to read, work and socialize at the Palatine Public Library District without unnecessary disturbance or distraction. Respecting the rights of others is a priority.

Choose the zone that is appropriate for your needs and please be considerate of others around you.

If you have any questions or comments please contact a Library staff member.



www.palatinelibrary.org

Main Library 700 N. North Court Palatine, IL 60067 847-358-5881	Rand Road Branch 1585 Rand Road Palatine, IL 60074 847-202-1194	North Hoffman Branch 3600 Lexington Drive Hoffman Estates, IL 60192 847-285-5440
Mon-Thu 9-9 Fri 9-6 Sat 9-5 Sun Noon-5	Mon & Thurs 10-6 Tues & Wed 9-6 Fri 9-4 Sat 9-1 Sun closed	Mon-Fri 11-7 Sat 9-3 Sun closed



Choose Your Zone

Noise Zones Guidelines



Choose your Noise Zone

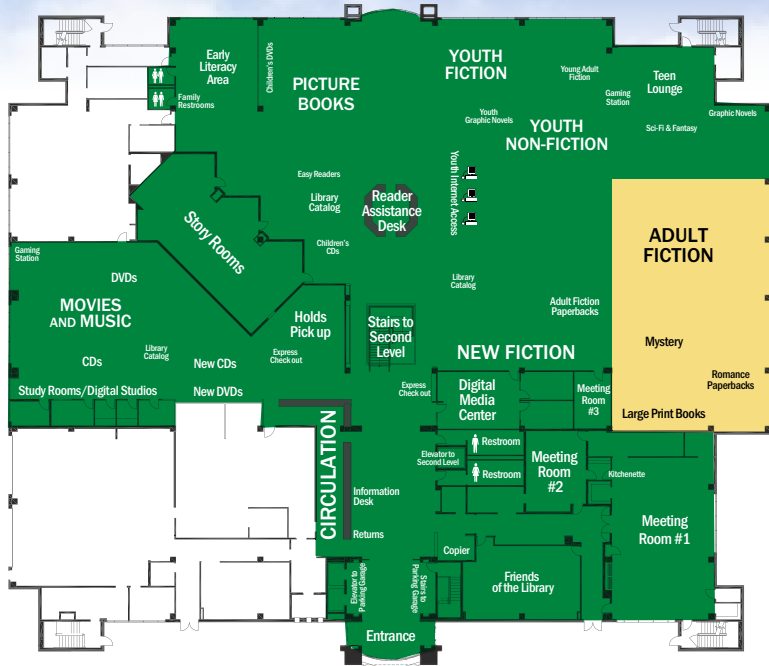

The 1st Floor has designated areas for Social and Moderate Noise Levels.

1st Floor Noise Zones



The **Social/Green Zone** is designated for those who wish to talk openly yet in a manner considerate of others.

- Audible and frequent conversations
- Considerate cell phone use
- No music noticeable to others
- Active patron area



The **Moderate/Yellow Zone** is designated for those who wish to work or read with a minimal disturbance.

- Minimal, brief & low-volume conversations
- No music noticeable to others
- Considerate cell phone use

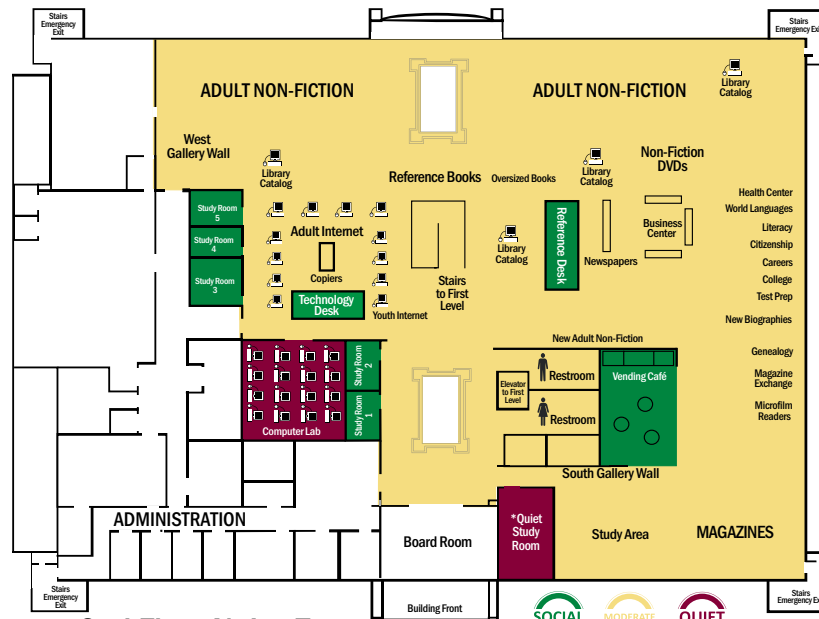

The 2nd Floor has designated areas for Social, Moderate and Quiet Noise Levels.

2nd Floor Noise Zones
2nd Floor Noise Zones



The **Quiet/Red Zone** is designated for those who wish to work or read with virtually no disturbance.

- No conversation
- No music noticeable to others
- No cell phone use

Note - *Quiet Study Room excludes laptops.



1st Floor Noise Zones

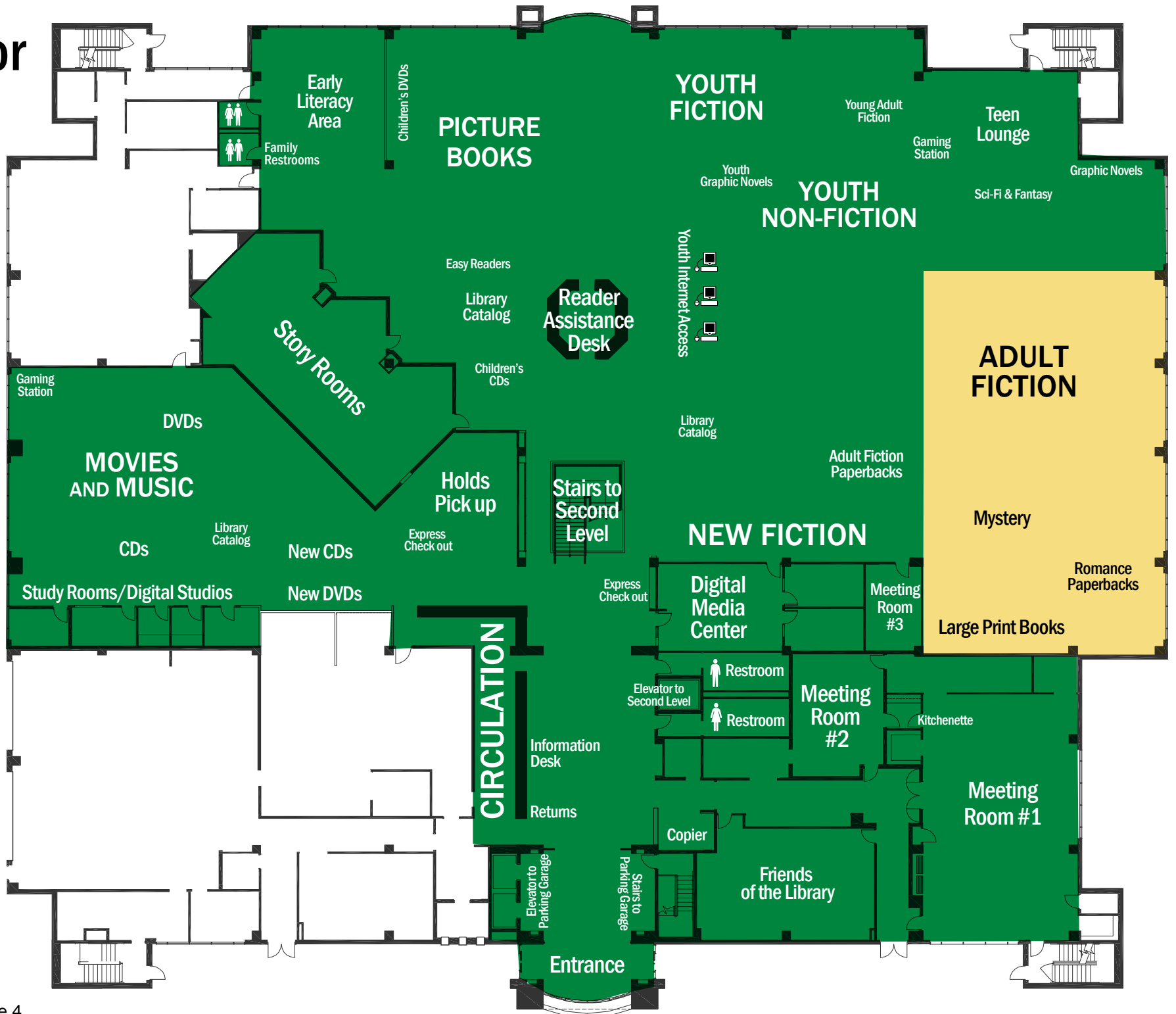

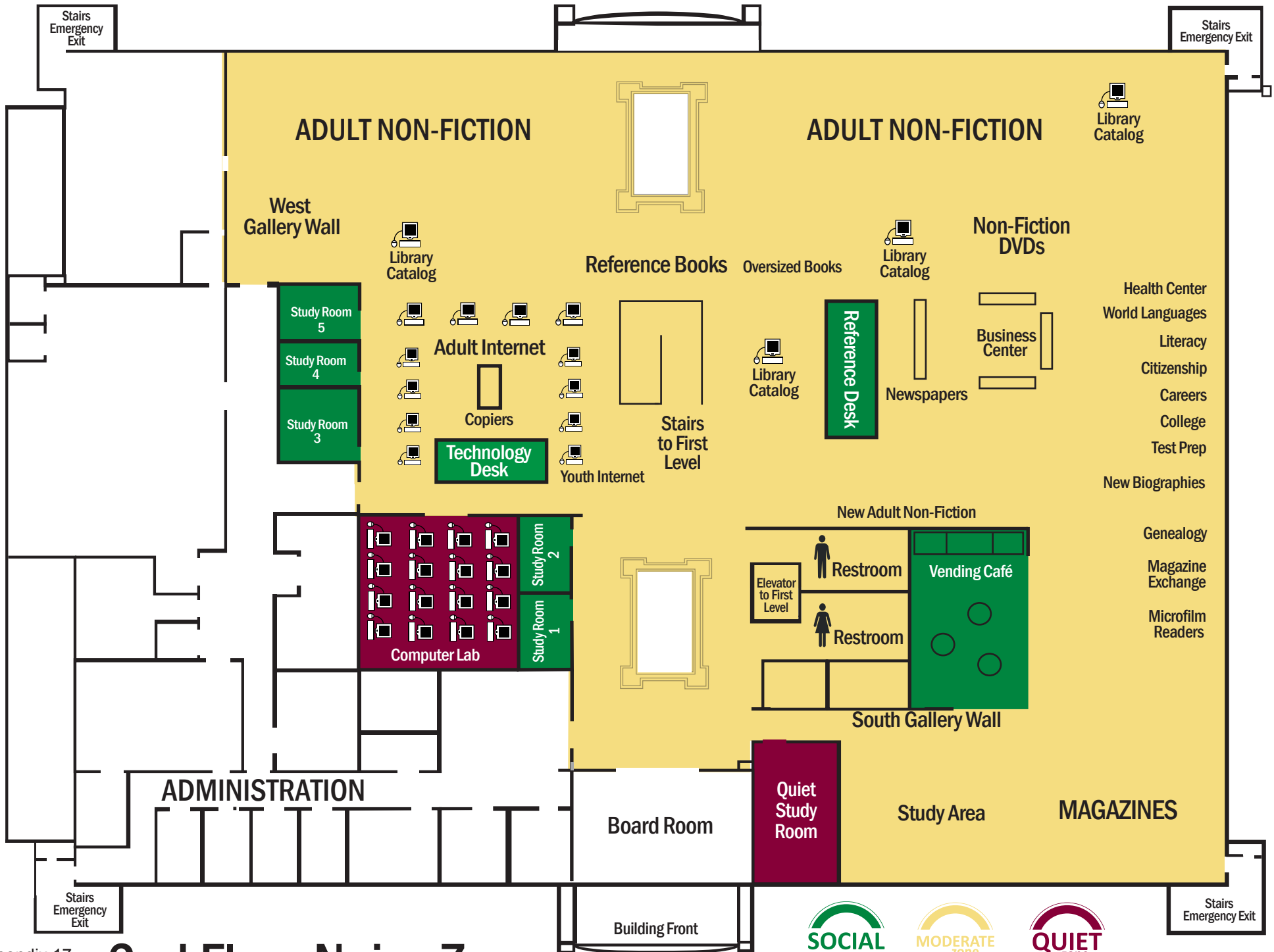

2nd Floor Noise Zones

